

VARIOLINE LAMP WITH SOCKET

LED 121/122

LED 121
On/off switch and
screw fixing

LED 122
Movement sensor and
magnet fixing



LED 121/122
magnet/screw
fixing

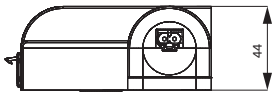

LED 121/122
side view

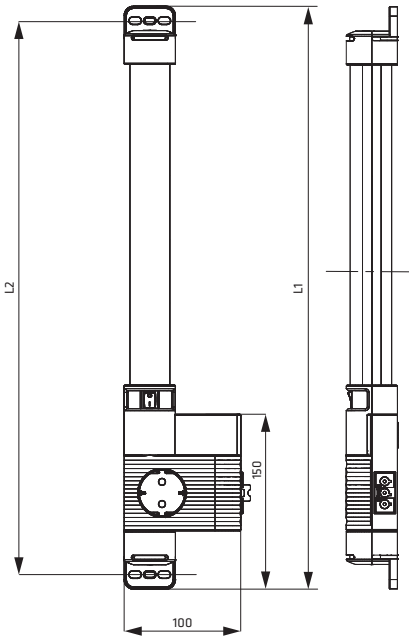

LED 121 (Size 1)
L1 = 500 mm
L2 = 475 mm

LED 122 (Size 2)
L1 = 700 mm
L2 = 675 mm

- > High luminous flux
- > Integrated socket
- > Durable and maintenance free LED technology

- > Integrated power unit
- > Daisy chain
- > On/off switch, movement sensor or connection for external door switch

The LED 121/122 Varioline is a powerful and compact LED lamp with integrated socket for use in enclosures. Featuring socket standards of many European countries as well as the US and Australia, it allows for the power connection of laptops and diagnostic devices. Its LED tube emits more than 1,000/1,700 Lm thereby illuminating even very large enclosures in their full depth and height. The glare-free, 120° rotatable light tube uses Mid-power LEDs with a service life of 60,000 h.



TECHNICAL DATA

| | |
|----------------------------------|--|
| Power consumption | max. 10 W/15 W |
| Operating voltage | AC 220 - 240 V, 50/60 Hz (min. AC 200 V, max. AC 265 V) AC 120 V, 50/60 Hz (min. AC 110 V, max. AC 130 V) |
| Luminous flux | 1,080 Lm/1,730 Lm |
| Lamp type | LED, angle of radiation 120° light color: daylight, color temperature: 6,500 K |
| Service life | 60,000 h at +20 °C (+68 °F) |
| Connection | 3-pole connector with snap lock AC: max. 16 A / AC 240 V, color: white |
| Mounting | magnet fixing or screw fixing (M5), torque 2 Nm max. |
| Casing | plastic, translucent |
| Dimensions | see drawings |
| Weight | approx. 0.3 kg/0.4 kg |
| Operating/Storage temperature | -40 to +40 °C (-40 to +104 °F) / -40 to +85 °C (-40 to +185 °F) |
| Operation/Storage humidity | max. 90 % RH (non-condensing) |
| Protection type/Protection class | IP20 / I (earthed) |

Mounting options: The lamps are available with magnet fixing for easy positioning in any steel cabinet or enclosure. A classic is the LED 121/122 with screw fixing. With a total rotation angle of 120° it provides perfect illumination.

Note: The lamp must not be used for household lighting.

View of magnet fixing

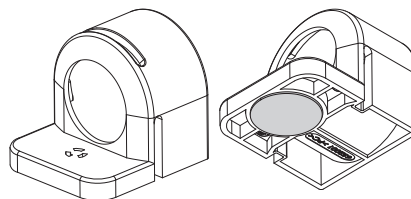

View of screw fixing

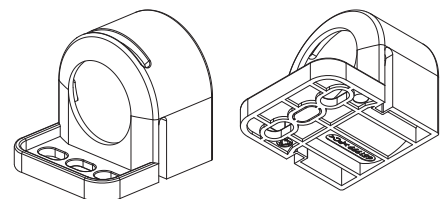

VARIOLINE LED 121/122 ON/OFF SWITCH

| Size 1: L1 = 500 mm | | Size 2: L1 = 700 mm | | Operating voltage | Socket | Nominal current of socket | Approvals | | |
|------------------------|-----------------------|------------------------|-----------------------|--------------------------|--------------------|---------------------------|-----------|---------------------|-----|
| Art. No. Magnet fixing | Art. No. Screw fixing | Art. No. Magnet fixing | Art. No. Screw fixing | | | | | | |
| 12100.0-30 | 12100.0-00 | 12200.0-30 | 12200.0-00 | AC 220 – 240 V, 50/60 Hz | Germany/Russia (1) | 16.0 A | VDE | - | EAC |
| 12101.0-30 | 12101.0-00 | 12201.0-30 | 12201.0-00 | AC 220 – 240 V, 50/60 Hz | FR/PL/CZ/SK (2) | 16.0 A | VDE | - | EAC |
| 12102.0-30 | 12102.0-00 | 12202.0-30 | 12202.0-00 | AC 220 – 240 V, 50/60 Hz | Switzerland (3) | 10.0 A | - | - | EAC |
| 12103.0-30 | 12103.0-00 | 12203.0-30 | 12203.0-00 | AC 220 – 240 V, 50/60 Hz | UK/Ireland (4) | 13.0 A | VDE | - | EAC |
| 12104.0-30 | 12104.0-00 | 12204.0-30 | 12204.0-00 | AC 120 V, 50/60 Hz | USA/Canada (5) | 15.0 A | - | UL File No. E234324 | EAC |
| 12105.0-30 | 12105.0-00 | 12205.0-30 | 12205.0-00 | AC 220 – 240 V, 50/60 Hz | Italy (6) | 16.0 A | VDE | - | EAC |
| 12107.0-30 | 12107.0-00 | 12207.0-30 | 12207.0-00 | AC 220 – 240 V, 50/60 Hz | Australia (7) | 10.0 A | VDE | - | EAC |

VARIOLINE LED 121/122 PIR MOVEMENT SENSOR¹

| Size 1: L1 = 500 mm | | Size 2: L1 = 700 mm | | Operating voltage | Socket | Nominal current of socket | Approvals | | |
|------------------------|-----------------------|------------------------|-----------------------|--------------------------|--------------------|---------------------------|-----------|---------------------|-----|
| Art. No. Magnet fixing | Art. No. Screw fixing | Art. No. Magnet fixing | Art. No. Screw fixing | | | | | | |
| 12110.0-30 | 12110.0-00 | 12210.0-30 | 12210.0-00 | AC 220 – 240 V, 50/60 Hz | Germany/Russia (1) | 16.0 A | VDE | - | EAC |
| 12111.0-30 | 12111.0-00 | 12211.0-30 | 12211.0-00 | AC 220 – 240 V, 50/60 Hz | FR/PL/CZ/SK (2) | 16.0 A | VDE | - | EAC |
| 12112.0-30 | 12112.0-00 | 12212.0-30 | 12212.0-00 | AC 220 – 240 V, 50/60 Hz | Switzerland (3) | 10.0 A | - | - | EAC |
| 12113.0-30 | 12113.0-00 | 12213.0-30 | 12213.0-00 | AC 220 – 240 V, 50/60 Hz | UK/Ireland (4) | 13.0 A | VDE | - | EAC |
| 12114.0-30 | 12114.0-00 | 12214.0-30 | 12214.0-00 | AC 120 V, 50/60 Hz | USA/Canada (5) | 15.0 A | - | UL File No. E234324 | EAC |
| 12115.0-30 | 12115.0-00 | 12215.0-30 | 12215.0-00 | AC 220 – 240 V, 50/60 Hz | Italy (6) | 16.0 A | VDE | - | EAC |
| 12117.0-30 | 12117.0-00 | 12217.0-30 | 12217.0-00 | AC 220 – 240 V, 50/60 Hz | Australia (7) | 10.0 A | VDE | - | EAC |

¹ approx. 5 min fixed switch-on duration

VARIOLINE LED 121/122 WITH CONNECTION FOR EXTERNAL DOOR SWITCH

| Size 1: L1 = 500 mm | | Size 2: L1 = 700 mm | | Operating voltage | Socket | Nominal current of socket | Approvals | | |
|------------------------|-----------------------|------------------------|-----------------------|--------------------------|--------------------|---------------------------|-----------|---------------------|-----|
| Art. No. Magnet fixing | Art. No. Screw fixing | Art. No. Magnet fixing | Art. No. Screw fixing | | | | | | |
| 12120.0-30 | 12120.0-00 | 12220.0-30 | 12220.0-00 | AC 220 – 240 V, 50/60 Hz | Germany/Russia (1) | 16.0 A | VDE | - | EAC |
| 12121.0-30 | 12121.0-00 | 12221.0-30 | 12221.0-00 | AC 220 – 240 V, 50/60 Hz | FR/PL/CZ/SK (2) | 16.0 A | VDE | - | EAC |
| 12122.0-30 | 12122.0-00 | 12222.0-30 | 12222.0-00 | AC 220 – 240 V, 50/60 Hz | Switzerland (3) | 10.0 A | - | - | EAC |
| 12123.0-30 | 12123.0-00 | 12223.0-30 | 12223.0-00 | AC 220 – 240 V, 50/60 Hz | UK/Ireland (4) | 13.0 A | VDE | - | EAC |
| 12124.0-30 | 12124.0-00 | 12224.0-30 | 12224.0-00 | AC 120 V, 50/60 Hz | USA/Canada (5) | 15.0 A | - | UL File No. E234324 | EAC |
| 12125.0-30 | 12125.0-00 | 12225.0-30 | 12225.0-00 | AC 220 – 240 V, 50/60 Hz | Italy (6) | 16.0 A | VDE | - | EAC |
| 12127.0-30 | 12127.0-00 | 12227.0-30 | 12227.0-00 | AC 220 – 240 V, 50/60 Hz | Australia (7) | 10.0 A | VDE | - | EAC |

VARIOLINE LED 121/122 WITHOUT SWITCHING OPTION

| Size 1: L1 = 500 mm | | Size 2: L1 = 700 mm | | Operating voltage | Socket | Nominal current of socket | Approvals | | |
|------------------------|-----------------------|------------------------|-----------------------|--------------------------|--------------------|---------------------------|-----------|---------------------|-----|
| Art. No. Magnet fixing | Art. No. Screw fixing | Art. No. Magnet fixing | Art. No. Screw fixing | | | | | | |
| 12130.0-30 | 12130.0-00 | 12230.0-30 | 12230.0-00 | AC 220 – 240 V, 50/60 Hz | Germany/Russia (1) | 16.0 A | VDE | - | EAC |
| 12131.0-30 | 12131.0-00 | 12231.0-30 | 12231.0-00 | AC 220 – 240 V, 50/60 Hz | FR/PL/CZ/SK (2) | 16.0 A | VDE | - | EAC |
| 12132.0-30 | 12132.0-00 | 12232.0-30 | 12232.0-00 | AC 220 – 240 V, 50/60 Hz | Switzerland (3) | 10.0 A | - | - | EAC |
| 12133.0-30 | 12133.0-00 | 12233.0-30 | 12233.0-00 | AC 220 – 240 V, 50/60 Hz | UK/Ireland (4) | 13.0 A | VDE | - | EAC |
| 12134.0-30 | 12134.0-00 | 12234.0-30 | 12234.0-00 | AC 120 V, 50/60 Hz | USA/Canada (5) | 15.0 A | - | UL File No. E234324 | EAC |
| 12135.0-30 | 12135.0-00 | 12235.0-30 | 12235.0-00 | AC 220 – 240 V, 50/60 Hz | Italy (6) | 16.0 A | VDE | - | EAC |
| 12137.0-30 | 12137.0-00 | 12237.0-30 | 12237.0-00 | AC 220 – 240 V, 50/60 Hz | Australia (7) | 10.0 A | VDE | - | EAC |

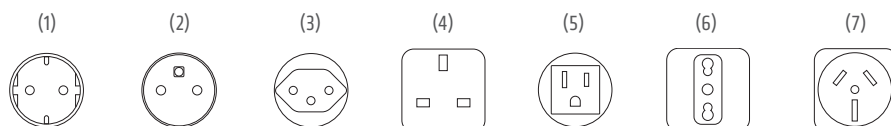

ACCESSORIES LED 121/122

Connectors and cables for electrical connection are not included in the delivery of the LED 121/122. These parts can be ordered separately. Sets, consisting of lamp and accessories, are available on request. Likewise, custom cables are available on request.

LAMP-SET WITH FEMALE CONNECTOR

▶ Varioline LED enclosure lamps are also available as a set including the connector Art. No. 264093. Simply add **-0003** to the article number of the required lamp. For example: 12100.0-30-**0003**. Sets for lamps with external door switch contain in addition the male connector 264090.

FEMALE / MALE CONNECTORS



Photo: Female connector, Art. No. 264093



Photo: Female connector, Art. No. 264091



Photo: Male connector, Art. No. 264090

| Art. No. | Model | Voltage type | Color | Use for | Wire cross-section ¹ | Approvals |
|----------|------------------|--------------|-------|-----------------------------|--------------------------------------|-----------|
| 264093 | female connector | AC | white | power input and daisy chain | 0,75-2,5 mm ² (AWG 14-18) | VDE + UL |
| 264091 | female connector | AC | white | power input | 0,75-2,5 mm ² (AWG 14-18) | VDE + UL |
| 264090 | male connector | AC | grey | door switch | 0,5-2,5 mm ² (AWG 14-20) | VDE + UL |

¹ applies to rigid and stranded wire. Wire end ferrules must be used when connecting with stranded wires

CONNECTION CABLE WITH FEMALE CONNECTOR AND OPEN END



Photo: Connection cable, Art. No. 244422

| Art. No. | Model | Length | Color | Use for | Approvals ² |
|----------|--|--------|--------------------------------|-------------|------------------------|
| 244422 | connection cable 3 x 1.5 mm ² with female connector | 4.0 m | connector: white; cable: white | power input | VDE |
| 244423 | connection cable 3 x AWG 16 with female connector | 4.0 m | connector: white; cable: white | power input | VDE + UL |

² applies only to the individual components (cable and connectors)

EXTENSION CABLE WITH 2 CONNECTORS FOR DAISY CHAIN CONNECTION



Photo: Extension cable, Art. No. 244358

| Art. No. | Model | Length | Color | Use for | Approvals ² |
|----------|---|--------|---------------------------------|-------------|------------------------|
| 244358 | extension cable 2 x 1.5 mm ² with 2 connectors | 1.0 m | connectors: white; cable: white | daisy chain | VDE |
| 244359 | extension cable 2 x AWG 16 with 2 connectors | 1.0 m | connectors: white; cable: white | daisy chain | VDE + UL |

² applies only to the individual components (cable and connectors)

CONNECTION CABLE WITH MALE CONNECTOR AND OPEN END

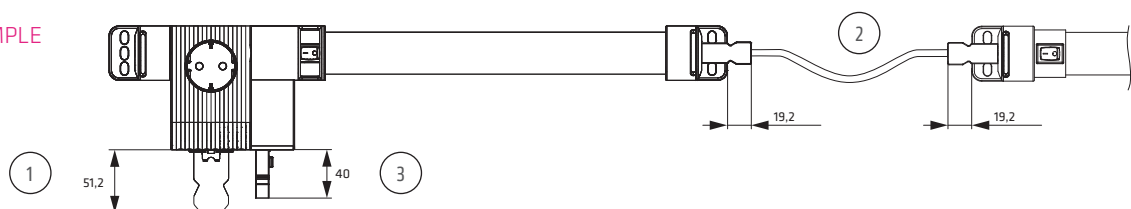

Photo: Connection cable, Art. No. 244424

| Art. No. | Model | Length | Color | Use for | Approvals ² |
|----------|--|--------|------------------------------------|--------------|------------------------|
| 244424 | connection cable 2 x 1.5 mm ² with male connector | 0.6 m | male connector: grey; cable: white | power output | VDE |
| 244425 | connection cable 2 x AWG 16 with male connector | 0.6 m | male connector: grey; cable: white | power output | VDE + UL |

² applies only to the individual components (cable and connectors)

CONNECTION EXAMPLE



The lamps are conveniently connected via connection plugs - up to 8 lamps max. can be daisy-chained this way. Female/male connectors are also available to assemble cables in non-standard lengths.